



Explora  
JOURNEYS

# EXPLORA I

EXPERIENCE HIGHLIGHTS

# INTRODUCING EXPLORA JOURNEYS

**EXPLORA JOURNEYS IS THE NEW LUXURY LIFESTYLE  
TRAVEL BRAND LAUNCHED BY THE MSC GROUP WITH THE  
AMBITION TO REDEFINE THE LUXURY CRUISE CATEGORY.**

The concept: Vibrant, cosmopolitan, relaxed European luxury at sea.  
Instead of cruises, we create journeys - of the mind, and across the oceans  
of the world. Visits to places on and off the beaten track.

On board: Spaces that offer guests relaxed luxury, creating a home at sea.  
Restoring life's essential balance with a combination of discovery and  
appreciation for wellbeing and nature. This is what our new discerning  
travellers have asked for and this is what they will enjoy on Explora Journeys.

**OUR JOURNEY BEGINS MAY 2023**



# EXPLORA | HIGHLIGHTS

THE FIRST OF FOUR LUXURY BEST-IN-CLASS SHIPS

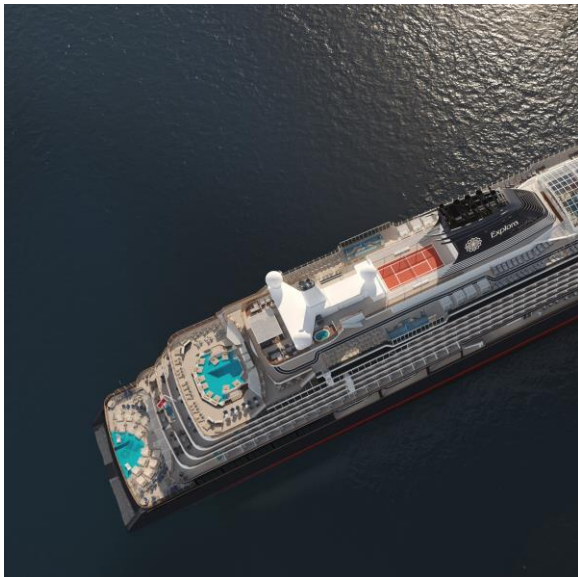

## 4 LUXURY CRUISE SHIPS BUILT BY FINCANTIERI IN ITALY

**2023**  
**EXPLORA I**

**2024**  
**EXPLORA II**

**2025**  
**EXPLORA III**

**2026**  
**EXPLORA IV**

## OVERVIEW

### 461 OCEAN FRONT SUITES

- 1 Owner's Residence
- 22 Ocean Residences
- 67 Ocean Penthouses
- 371 Ocean Suites
- 82 multi-gen-friendly connecting suites

#### Featuring

- Private terraces that are amongst the largest in the category
- Large floor-to-ceiling windows with elegant interiors
- Spacious walk-in wardrobe with a seated vanity area

### 9 DISTINCT INCLUSIVE DINING EXPERIENCES

- Focused on healthy, delicious food from local, sustainable sources

### NUMEROUS LOUNGING AND ENTERTAINMENT OPTIONS

- Several indoor and outdoor bar and lounge experiences with curated entertainment and intimate performances
- Casino, art gallery and curated shopping experiences

### GENEROUS OUTDOOR DECKS

- Three outdoor pools and one indoor pool with retractable glass roof
- 64 private cabanas
- Several indoor and outdoor whirlpools
- Poolside dining and lounging

### HOLISTIC WELLNESS AND FITNESS

- Over 700 sqm (7,500 sq ft) of indoor and outdoor wellness facilities
- Spacious thermal area
- Nine treatment rooms
- Beauty salon
- Over 270 sqm (2,900 sq ft) of fitness facilities with latest equipment
- Fitness studio for group or personal trainings
- Panoramic running track

### THE LATEST ENVIRONMENTAL- SUPPORTING TECHNOLOGIES

- Hybrid-ready energy solutions
- Waste-management and energy-saving solutions
- No single-plastic used on-board and ashore





# TECHNICAL CHARACTERISTICS

GROSS TONNAGE	63,900 GT	NUMBER OF SUITES	461
LENGTH OVERALL	248 M (~ 813 FT)	NUMBER OF GUESTS	~ 900
BEAM	~ 32 M (~ 105 FT)	NUMBER OF TEAM MEMBERS	640
HEIGHT ABOVE WATERLINE	56 M (~ 184 FT)	GUESTS PER TEAM MEMBER RATIO CATEGORY-LEADING	1.25 : 1
SPEED (MAX)	18 KNOTS	TOTAL PUBLIC SPACE	~ 16,600 SQM (~ 178,680 SQ FT)
NUMBER OF DECKS	14	TOTAL OUTDOOR PUBLIC SPACE	~ 6,250 SQM (~ 67,275 SQ FT)
		OUTDOOR SPACE PER GUEST	6,5 SQM (~ 70 SQ FT)

# ENVIRONMENTAL SUPPORTING FEATURES

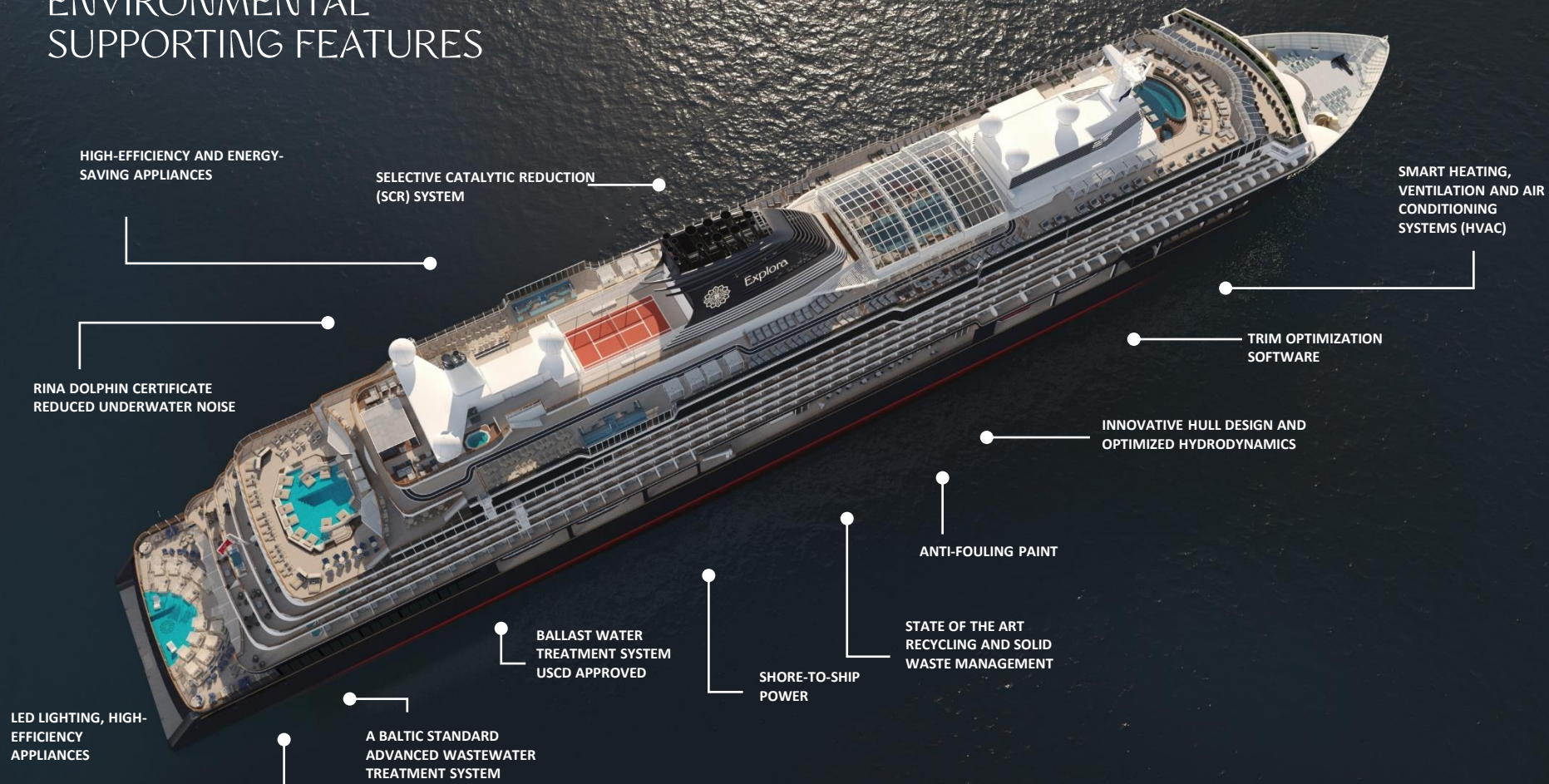

HIGH-EFFICIENCY AND ENERGY-SAVING APPLIANCES

SELECTIVE CATALYTIC REDUCTION (SCR) SYSTEM

SMART HEATING, VENTILATION AND AIR CONDITIONING SYSTEMS (HVAC)

TRIM OPTIMIZATION SOFTWARE

RINA DOLPHIN CERTIFICATE REDUCED UNDERWATER NOISE

INNOVATIVE HULL DESIGN AND OPTIMIZED HYDRODYNAMICS

ANTI-FOULING PAINT

STATE OF THE ART RECYCLING AND SOLID WASTE MANAGEMENT

SHORE-TO-SHIP POWER

BALLAST WATER TREATMENT SYSTEM USCD APPROVED

A BALTIC STANDARD ADVANCED WASTEWATER TREATMENT SYSTEM

LED LIGHTING, HIGH-EFFICIENCY APPLIANCES





## ...AND SUSTAINABILITY INITIATIVES

- Support and giving back to noble environmental causes through the MSC Foundation
- Spotlights on local talents, craftsmanship, culture, gastronomy, traditions
- Destination experiences: leaving a positive impression and footprint on the places and people we visit
- Suppliers' certification
- Crew welfare: development, training, diversity

## THE PERFECT HOSTS

**OUR PERFECT HOSTS WELCOME OUR GUESTS TO A REFINED AND GENEROUS ALL-INCLUSIVE JOURNEY.**



LOWER POOL ON DECK 5

### ALL JOURNEYS INCLUDE

- Authentic, intuitive service from our team of hospitality experts
  - Sophisticated dining at 10 culinary venues, including In-suite dining
  - Unlimited beverages, fine wines and premium spirits, specialty coffees, teas and soft drinks available at all times, including in-suite mini-bar
  - Access to the spa thermal area
  - Wellbeing and fitness programs on-board and at the destinations
  - All on-board gratuities
  - High-speed unlimited Wi-Fi throughout the ship
  - In-suite welcome bottle of champagne
  - Shuttle services from port to city centre  
*(where required/available)*
- Plus additional inclusions and services for guests staying in Penthouses and Residences

# SUITES, PENTHOUSES AND RESIDENCES

OCEAN-FRONT, HOME-LIKE COMFORT AT SEA

## HOMES AT SEA

**EACH OF OUR 461 OCEAN-FRONT SUITES, PENTHOUSES AND RESIDENCES – ALL DESIGNED WITH A REFINED, EUROPEAN ELEGANCE – ARE CREATED TO GET YOU CLOSER TO THE OCEAN ITSELF, WITH FLOOR-TO-CEILING WINDOWS AND PRIVATE SUN TERRACES.**

With unrivalled space and privacy, and service that means everything is taken care of, our guests can relax into their comfortable homes at sea with their luggage delivered and a chilled bottle of champagne waiting as they undertake their Ocean Journey. Our suites start at 35 sqm (377 sq ft), among the most spacious for the category.



OCEAN PENTHOUSE





Welcome

Ms. & Mr. Jo

OCEAN PENTHOUSE

# FEATURES AND SERVICES



OCEAN PENTHOUSE

## IN-SUITE TECHNOLOGY

- Complimentary Wi-Fi
- Infotainment system with Smart TV and easy connectivity to personal devices
- Smartphone app for access to all services
- Telephones with voicemail
- On-demand TV options
- Wireless charging base on bedside tables
- Individual climate control in each suite

## SERVICES

- 24-hour butler services<sup>1</sup>
- 24-hour concierge services
- 24-hour in-suite dining
- 24-hour laundry, dry-cleaning and ironing services<sup>2</sup>
- Twice-daily housekeeping services, including evening turndown service
- Shoeshine service

## BUTLER SERVICES<sup>1</sup>

- Packing and unpacking to the guests' preferences
- Pressing and laundering assistance
- Private in-suite dining
- Personal communication through our app and on messenger platforms
- Itinerary and transport planning
- Celebrations planning
- Onboard and ashore reservations assistance

<sup>1</sup> Available for Ocean Residences

<sup>2</sup> Additional charges may apply

## GUEST SUITES OVERVIEW

	Suite Name	Decks	Total Suite Area, sqm (~sq ft)	Suite Area, sqm (~sq ft)	Terrace Area, sqm (~sq ft)	Qty
<b>371 OCEAN SUITES</b>	OCEAN TERRACE SUITE OT1/OT4	6-7-8-9-10	35 (377)	28 (301)	7 (75)	301
	OCEAN GRAND TERRACE SUITE GT	6-7	39 (420)	28 (301)	11 (118)	70
<b>67 OCEAN PENTHOUSES</b>	PENTHOUSE PH	7-8-9	43 (463)	34 (366)	9 (97)	7
		6	48 (517)	34 (366)	14 (151)	
	DELUXE PENTHOUSE DP	9-10	48 (517)	38 (409)	10 (108)	10
		6	53 (570)	43 (463)	10 (108)	
	PREMIER PENTHOUSE PP	7	61 (657)	43 (463)	18 (194)	40
		8-9-10	52 (560)	42 (452)	10 (108)	
	GRAND PENTHOUSE GP	7-8-9-10	60 (646)	47 (506)	13 (140)	10
		6	68 (732)	47 (506)	21 (226)	
<b>22 OCEAN RESIDENCES</b>	COVE RESIDENCE CO	7-8-9-10	70 (753)	56 (603)	14 (151)	10
		6	80 (861)	56 (603)	24 (258)	
	RETREAT RESIDENCE RR	8-9	77 (829)	63 (678)	14 (151)	6
		7	81 (872)	63 (678)	18 (194)	
	SERENITY RESIDENCE SR	7	113 (1,216)	60 (646)	53 (570)	4
		9	126 (1,356)	60 (646)	66 (710)	
	COCOON RESIDENCE CR	6	149 (1,604)	74 (797)	75 (807)	2
<b>1 OWNER'S RESIDENCE</b>	OWNER'S RESIDENCE OR	8	280 (3,014)	155 (1,668)	125 (1,345)	1

**Total 461**

## 9 ACCESSIBLE OCEAN SUITES

# 1 ACCESSIBLE OCEAN PENTHOUSES

**Total**      **10**





OCEAN SUITE

## SUITE ACCESSIBILITY FEATURES

- Bathtub with grab bar and seat
- Roll-in shower
- Grab-bar in shower
- Fold-down seat in the shower (height of seat from the floor is 450 mm / 17.7 in)
- Grab-bar next to toilet seat
- Portable toilet seat risers available on board
- Hand-held shower wand
- Lowered towel racks
- Accessibility equipment for hearing impaired (Assistive Listening System (ALS) and/or TTY devices)
- Lowered wardrobe bars and shelving
- Lowered safe
- Double peephole on entrance door
- All doorways wheelchair accessible,
- entrance door width 900 mm (31.5 in), bathroom door width 900 mm (31.5 in)

Features may vary by suite. Please inform your Travel Advisor or the Explora Experience Centre Ambassador of your needs when booking.

# ONBOARD EXPERIENCES

**HOW EXPLORA JOURNEYS CREATES ENRICHING EXPERIENCES  
FOR THE MIND, BODY AND SOUL**

## DINING

### **A DIVERSITY OF CULINARY RICHES**

Explora Journeys brings  
personality, sophistication  
and a dash of soul to  
dining at sea.









## DINING

### CUISINE COVERING ALL CORNERS OF THE GLOBE

Nine culinary experiences (as well as in-suite dining) to discover - each distinct but every one created to celebrate global cooking talents, provenance and wholesome ingredients sourced by local partners

#### CULINARY EXPERIENCES

- Effortless all-day dining restaurant
- Sophisticated concept restaurant showcasing up-and-coming chefs from around the globe
- Pan Asian restaurant
- Steakhouse experience
- Mediterranean-style restaurant
- International-style restaurant
- Coffee lounge
- Poolside dining
- Chef's kitchen with private dining and culinary school
- In-suite dining



# CULINARY EXPERIENCES - LOCATIONS

## DECK 4

Mediterranean-style restaurant

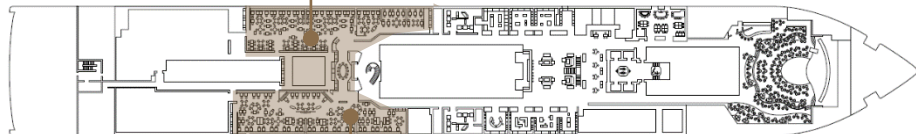

International-style restaurant

All-day dining restaurant (indoor)

## DECK 11

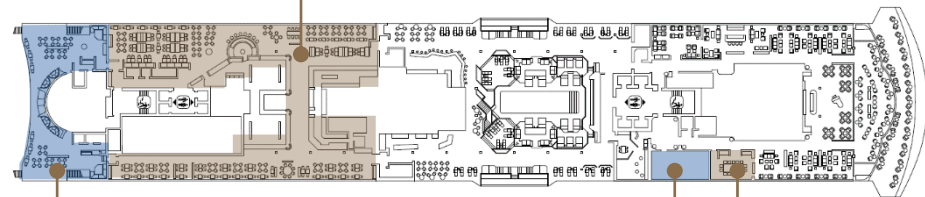

All-day dining restaurant (outdoor)

Chef's Kitchen (culinary school)

Chef's Kitchen (private dining room)

## DECK 5

Pan-Asian restaurant

Steakhouse

Concept restaurant

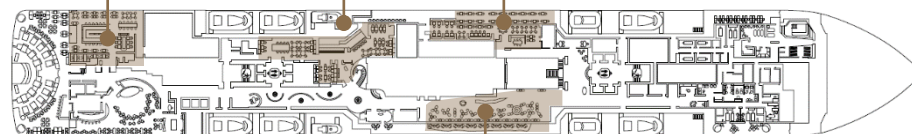

Coffee lounge

	Deck	Indoor Seating	Outdoor Seating	Total Seating
All-day dining	11	284	90	374
Pan-Asian	5	80	26	106
Steakhouse	5	96	10	106
Concept	5	50	24	74
International-style	4	216	-	216
Mediterranean-style	4	190	-	190
Chef's Kitchen	10	12	-	12
Coffee lounge	5	68	16	84

## LOUNGING

### REIMAGINING ENTERTAINMENT WITH THE RIGHT VIBE FOR THE RIGHT TIME

An effortless, cosmopolitan atmosphere in which to discover, enjoy and appreciate diverse talents from around the world.

The perfect blend of vibrancy and privacy across more than 10 indoor and outdoor bars and lounges.

#### LOUNGING & ENTERTAINMENT EXPERIENCES

- Lobby bar
- Observation lounge
  - Lounge
  - Whisky bar & cigar room
  - Chef's kitchen and private dining room
- Main lounge
- Poolside aft lounge
- Coffee lounge
- Several poolside and outdoor bars and lounges
- Casino
- Art gallery
- Curated shopping experiences









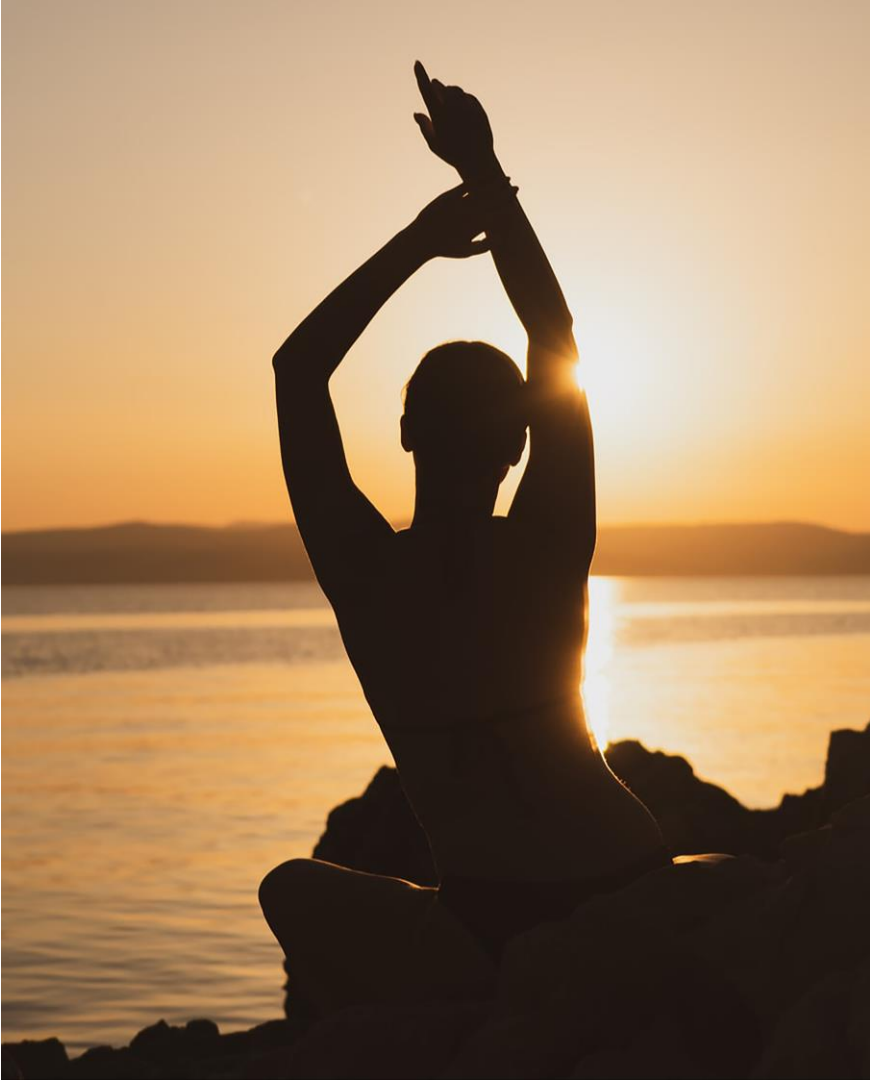

## WELLBEING

### **A COMPREHENSIVE AND HOLISTIC WELLBEING EXPERIENCE INSPIRED BY OUR LOVE FOR THE SEA**

From treatment rooms to state-of-the-art fitness equipment, group workout classes to personal training appointments, tailor-made programmes make keeping well while on holiday effortless and enjoyable.

Bespoke wellness experiences at each destination will make relaxation and rejuvenation easily accessible both onboard and ashore.

# WELLBEING

## WELLBEING EXPERIENCES

- Over 700 sqm (7,535 sq ft) of indoor and outdoor spa facilities for pure relaxation and wellness
- Over 270 sqm (2,906 sq ft) of fitness facilities with the latest equipment
- A panoramic running track
- Wellness experiences in each destination will make relaxation and rejuvenation enjoyable onboard and ashore
- Bespoke balanced nutrition and sleep programmes
- A fitness studio for group or personal training



## LEISURE EXPERIENCE

### AN EXPERIENCE INSPIRED BY SEAS AND OCEANS

Generous outdoor decks – offering more than 2,500 sqm (26,909 sq ft) of spectacular sea views – combined with numerous indoor and outdoor whirlpools on the ship's promenade deck

#### LEISURE EXPERIENCES

- Three outdoor pools
- 64 private cabanas
- Multiple indoor and outdoor whirlpools
- One indoor pool with retractable glass roof, largest and only in category at 1,200 sqm (12,917 sq ft)







LOWER POOL ON DECK 5



INDOOR POOL WITH GLASS ROOF



PANORAMIC POOL ON DECK 12



UPPER POOL ON DECK 10





EXPLORA I  
VALLETTA



Explora  
JOURNEYS

FEEL THE  
OCEAN STATE OF MIND

FOR MORE INFORMATION, PLEASE CONTACT:  
[TRAVELPARTNERS@EXPLORAJOURNEYS.COM](mailto:TRAVELPARTNERS@EXPLORAJOURNEYS.COM)